

# Ball Valve

DN 1/2" - 2"  
ASME Class 800



INNO-BALL

## Design

1. The valve is designed in accordance with BS-5351, MSS SP-118
2. Ends acc. ASME B 16.11 (SW), ASME B1.20.1 (Thrd Ends), ASME B16.25 (BW)
3. Test & Inspection API 598

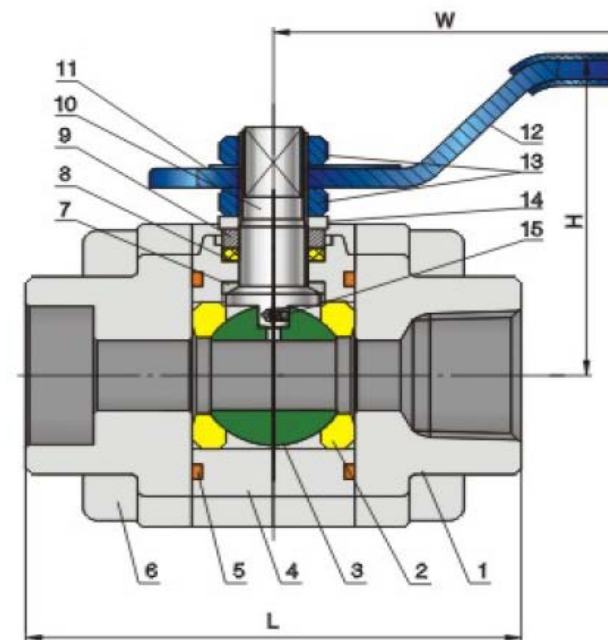
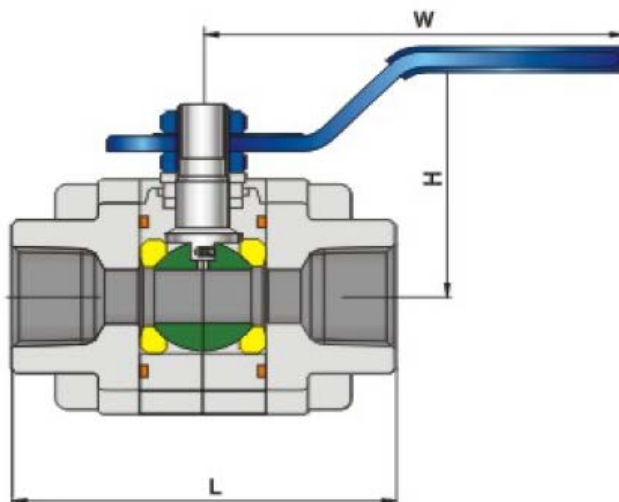

## Dimensions (in mm)

Size DN	1/2"	3/4"	1"	1 1/2"	2"
L	73	88	105	128	146
H	52	60	65	93	110
W	120	145	145	175	260
Bore	14	20,5	25	38	49
Weight (kg)	1.1	1.9	2.4	4.9	8.7

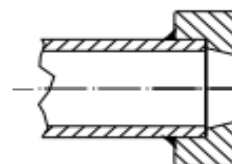

Nipple Ends

## INNO-BALL

**Material** (DIN-Material on request)

Item	Part name	Carbon steel to ASTM Type A105	Alloy steel to ASTM Type LF2	Alloy steel to ASTM Type F304	Alloy steel to ASTM Type F316	Stainless steel to ASTM Type F51
1	Bonnet	A105	LF2	F304	F316	F51
2	Seat	RPTFE & Peek	RPTFE & Peek	RPTFE & Peek	RPTFE & Peek	RPTFE & Peek
3	Ball	F6	F304	F304(L)	F316(L)	F51
4	Body	A105	LF2	F304(L)	F316(L)	F51
5	O-Ring	Viton	Viton	Viton	Viton	Viton
6	Stud	B8	B8	B8	B8M	B8M
7	Gasket	PTFE	PTFE	PTFE	PTFE	PTFE
8	Packing Bushing	PTFE	PTFE	PTFE	PTFE	PTFE
9	Gland	410	304	F304(L)	F316(L)	F51
10	Stem	410	304	F304(L)	F316(L)	F51
11	Nameplate	Al	Al	Al	Al	Al
12	Lever	1045+Zn	1045+Zn	1045+Zn	1045+Zn	1045+Zn
13	Nut	2H	8M	8M	8M	8M
14	Elastic Washer	65Mn	65Mn	304	304	304
15	Anti-Static Spring	304	304	304	316L	316L

**Special materials on request.**

### Specification

Marking	EN19, CE
Pressure-Temperature Rating	ASME B16.34
Valve Inspection, Testing	API 598
	AD-2000 and EN 12266-2 (DIN 3230 part 3) on request

All of our valves are subject to a steady technological progress and improvement. So details might change without prior notification.